

5/26/20

* INCIDENTAL MILLING AT LOCATIONS AS DIRECTED BY THE ENGINEER

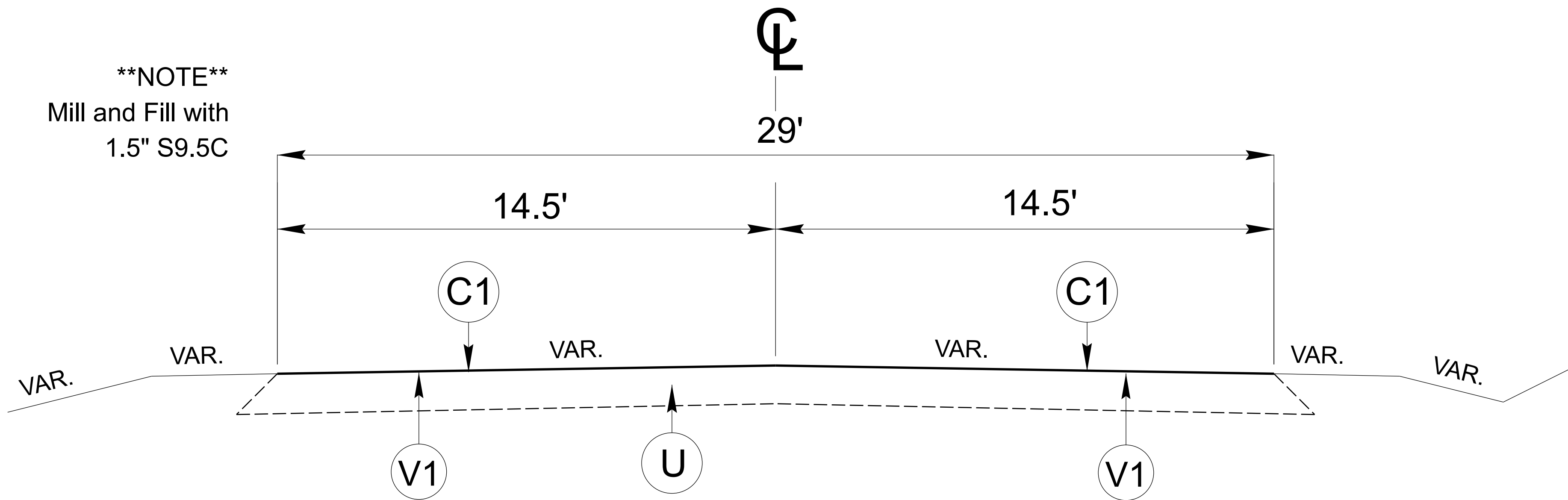

TYPICAL SECTION NO. 1

** MAP 1 - US 601 N/ ROCKFORD ST FROM OLD HWY 601 TO MP 14.4
**(See Typical No.2 for bridge overlay location)

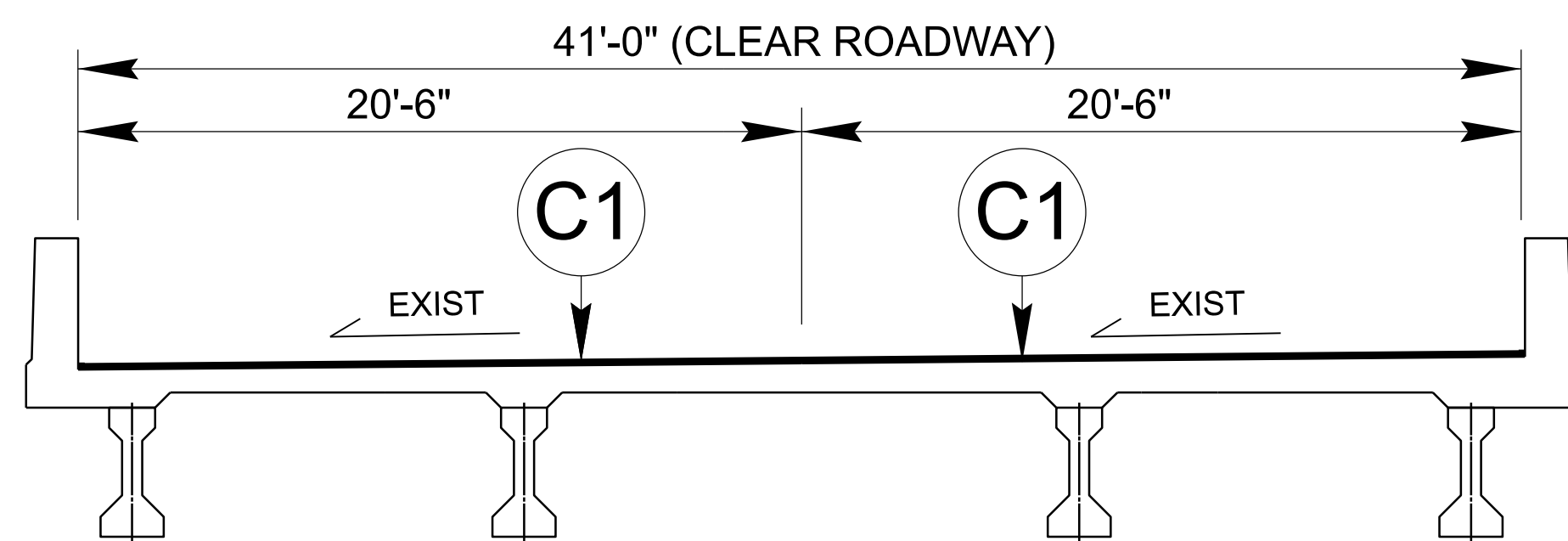

NOTE: EXISTING BRIDGE SUPERSTRUCTURE #59

TYPICAL SECTION NO. 2

MAP 1 - US 601 FROM MP 10.76 TO 10.78

[NOTE: MP IS REFERENCED FROM GOINC MAPS]

PAVEMENT SCHEDULE	
C1	PROP. APPROX. 1 1/2" ASPHALT CONCRETE SURFACE COURSE, TYPE S9.5C, AN AVERAGE RATE OF 168 LBS. PER SQ. YD.
U	EXISTING PAVEMENT
V1	MILLING OF EXISTING ASPHALT PAVEMENT AT DEPTH OF 1 1/2"
V2	INCIDENTAL MILLING (See Tie in Detail)

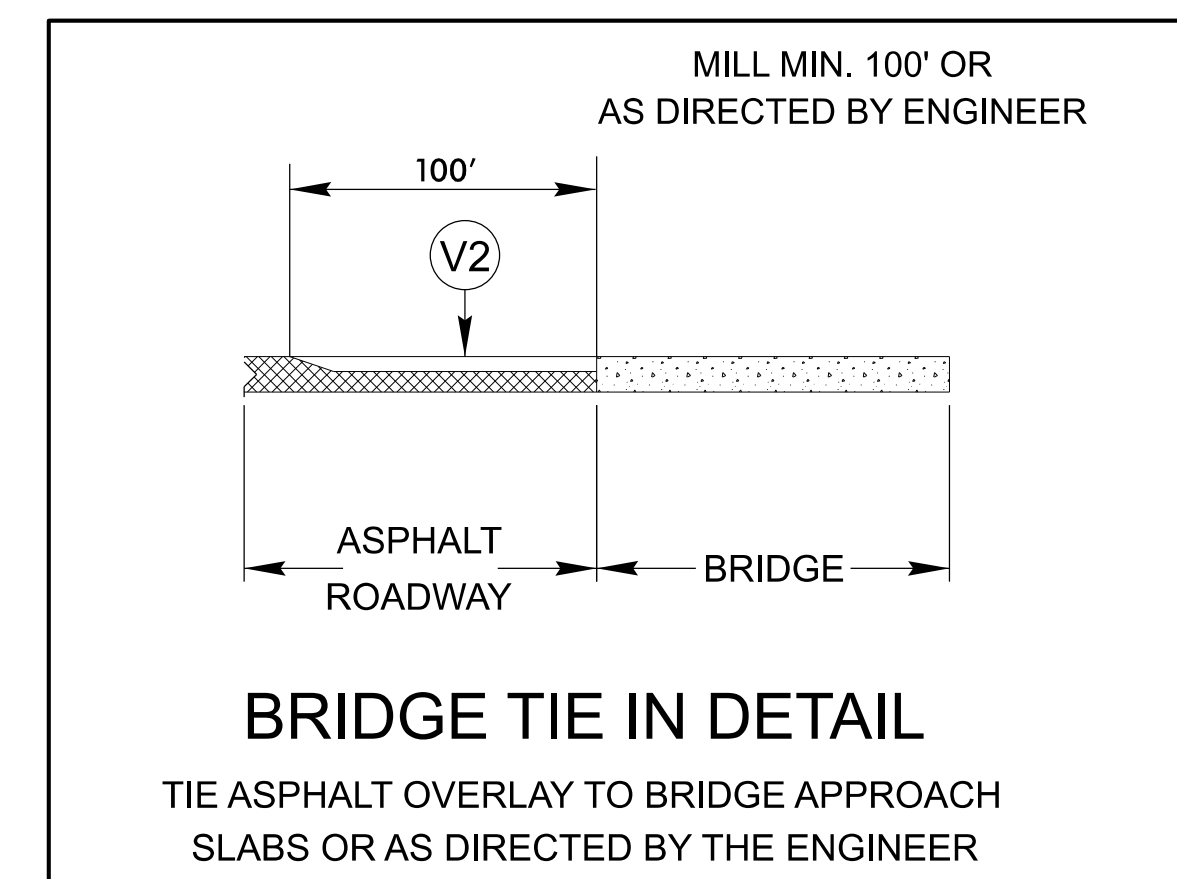
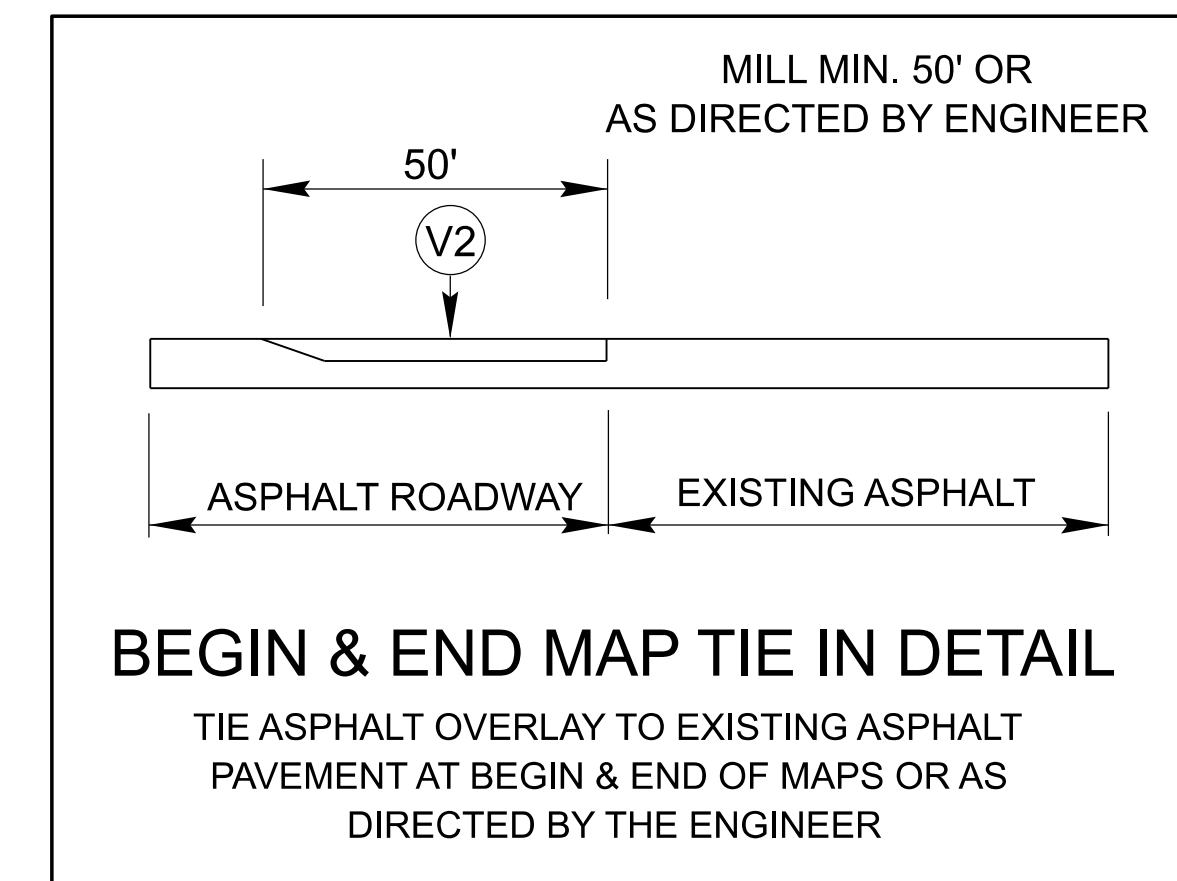

NOTE: TYPICALS ARE NOT TO SCALE

DK00470

001

NORTH CAROLINA DEPARTMENT OF TRANSPORTATION DIVISION OF HIGHWAYS

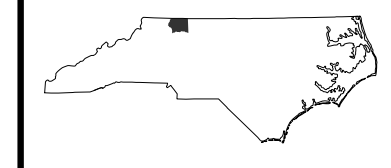

DIVISION ELEVEN

SURRY COUNTY

PRIMARY ROADS

2026 ASPHALT RESURFACING

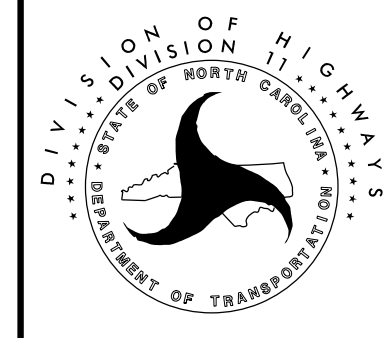

DATE: 2/10/2026 PREPARED BY: DLH

REVISIONS

PROJECT NO.	SHEET NO.
DK00470	2

SUMMARY OF QUANTITIES

												1220000000-E	1297000000-E	1330000000-E	1523000000-E	1575000000-E
PROJECT NO	COUNTY	MAP NO	ROUTE	DESCRIPTION	TYP NO	LANES	LANE TYPE	LENGTH	WIDTH	BEGIN MP	END MP	INCIDENTAL STONE BASE	1½" MILLING	INCIDENTAL MILLING	SURFACE COURSE, S9.5C	ASPHALT BINDER FOR PLANT MIX
								MI	FT			TONS	SY	SY	TONS	TON
2026CPT.11.09.10861	Surry	1	US-601 N / ROCKFORD ST	FROM OLD HWY 601 TO MP 14.4		2		3.850	29	10.550	14.400	84	65,501	8,822	6,644	392
TOTAL FOR PROJ NO. 2026CPT.11.09.10861								3.850				84	65,501	8,822	6,644	392
GRAND TOTAL								3.850				84	65,501	8,822	6,644	392

[MILE POST MAPS](#)

													PROJECT NO.	SHEET NO.			
													DK00470	3			
THERMOPLASTIC AND PAINT QUANTITIES																	
												4413000000-E	4725000000-E			4890000000-E	4895000000-N
PROJECT NO	COUNTY	MAP NO	ROUTE	DESCRIPTION	TYP NO	LANES	LANE TYPE	LENGTH	WIDTH	BEGIN MP	END MP	WORK ZONE ADVANCE/GENERAL WARNING SIGNING	THERMOPLASTIC STRAIGHT ARROW, 90 MIL	THERMOPLASTIC LEFT ARROW, 90 MIL	THERMOPLASTIC RIGHT ARROW, 90 MIL	HOT SPRAY THERMOPLASTIC PAVEMENT MARKING LINES, 4", 65 MIL	POLYCARBONATE H-SHAPED MARKER
								MI	FT			SF	EA	EA	EA	LF	EA
2026CPT.11.09.10861	Surry	1	US-601 N / ROCKFORD ST	FROM OLD HWY 601 TO MP 14.4	1	2		3.85	29	10.55	14.4	310	4	17	12	81,312	254
TOTAL FOR PROJ NO. 2026CPT.11.09.10861								3.85				310	4	17	12	81,312	254.000
													33				
GRAND TOTAL								3.85				310	4	17	12	81,312	254.000
													33				

[MILE POST MAPS](#)

Map # 1
US 601 N. / Rockford St
FROM Old Hwy 601
TO MP 14.4

Surry County
DK00467
Map #1



BUS
601

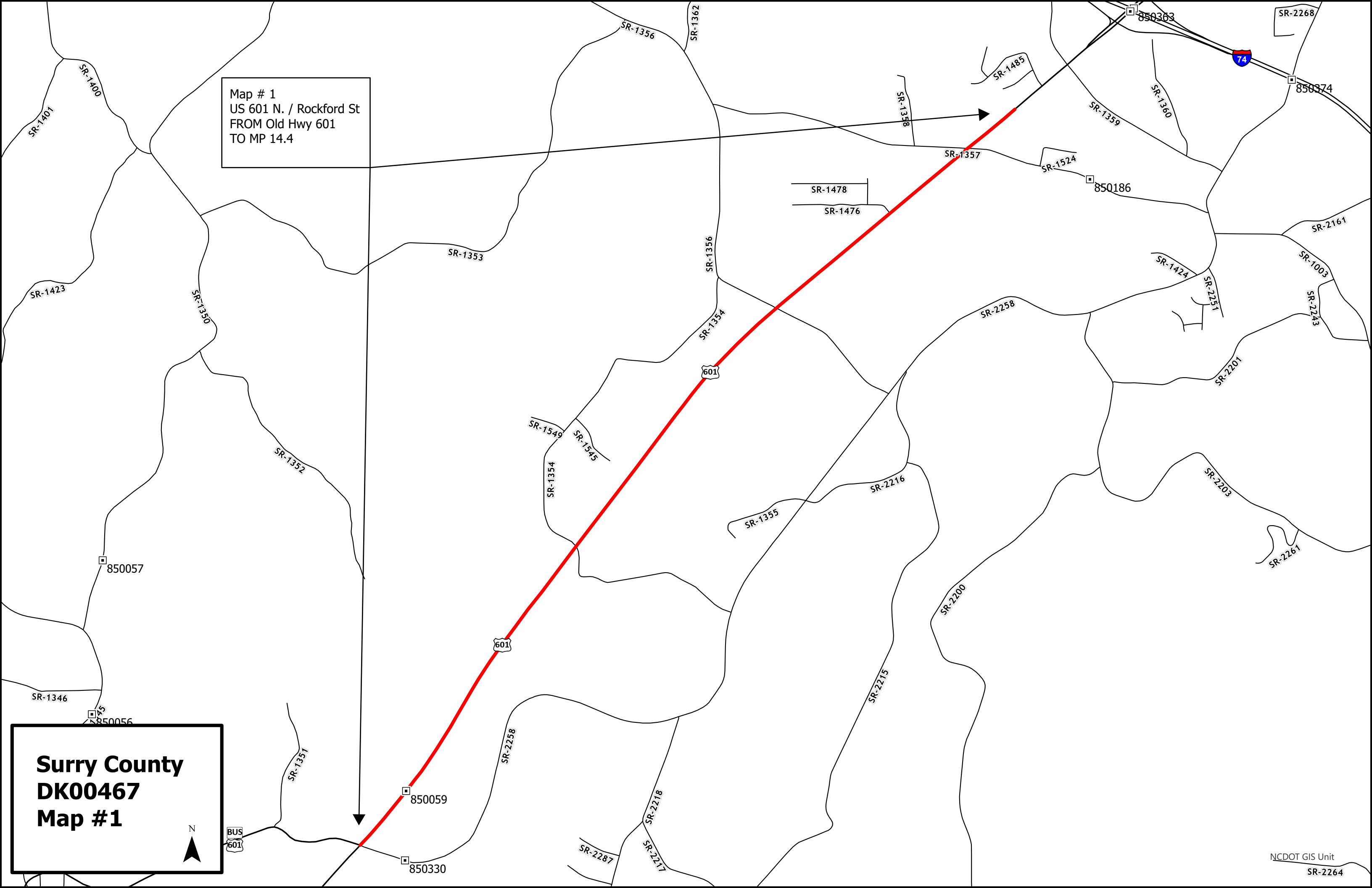

SIGNING FOR RESURFACING PROJECTS

LEGEND
 ┆ STATIONARY SIGN
 ← DIRECTION OF TRAFFIC FLOW

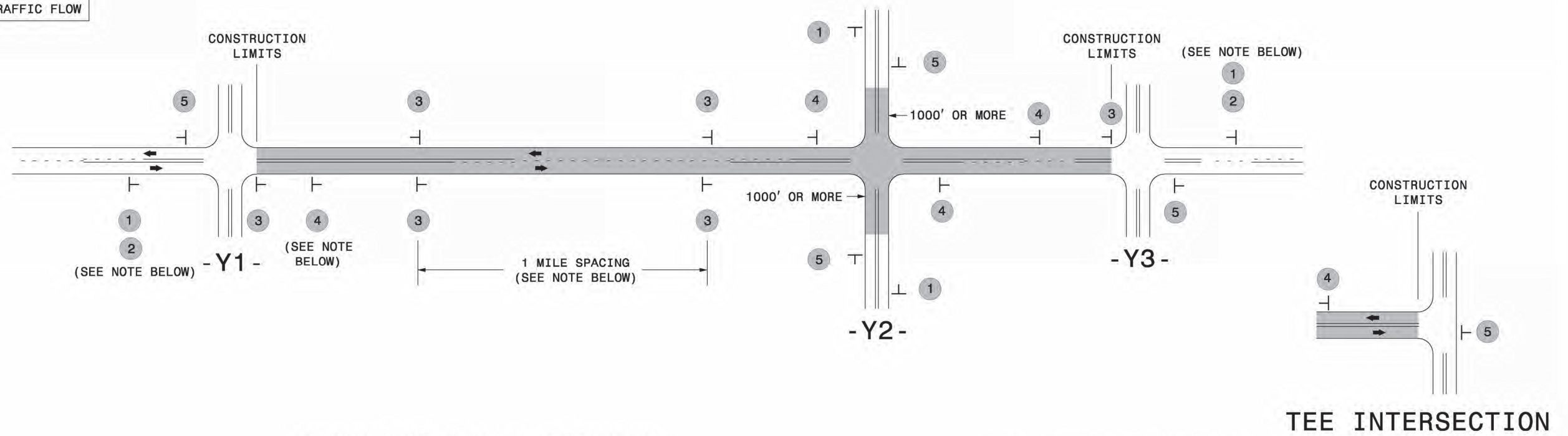

MAINLINE (-L-) SIGNING

-Y- LINE SIGNING

SIGNING NOTES AND PLACEMENT PER DIRECTION	1	 W20-1 48" X 48"	PLACE 1000' PRIOR TO BEGINNING OF CONSTRUCTION LIMITS. ONLY USED ON -Y- LINES IF RESURFACING LIMITS EXTEND 1000' ALONG -Y- LINE.	
	2	 W7-3aP 24" X 18"	#2 SIGN ONLY USED WHEN CONSTRUCTION LIMITS ARE 2 OR MORE MILES IN LENGTH. ROUND UP TO NEXT WHOLE NUMBER. (NO FRACTIONAL OR DECIMAL NUMBERS)	
	3	 SP 13107 48" X 48"	- PLACE INITIALLY AT THE CONSTRUCTION LIMITS AND SPACE 1 MILE APART THEREAFTER. - AT TEE INTERSECTIONS INSTALL INITIALLY 1/2 MILE FROM INTERSECTION AND SPACE 1 MILE APART THEREAFTER.	
	4	 SP 13106 48" X 48"	- THESE ARE FOR -Y- LINES THAT ARE "THROUGH" ROADWAYS. - DEAD END AND SUBDIVISION ROADS ARE NOT "THROUGH" ROADWAYS. - INSTALL 500' +/- FROM EACH -Y- LINE APPROACH AS SHOWN ABOVE. - FOR MULTIPLE -Y- LINES THAT ARE SEPARATED BY 0.25 MILES OR LESS, TREAT AS A SINGLE UNIT AND INSTALL WITHIN 500' OF EACH APPROACH. - A MAXIMUM OF 2 SIGN SETS PER MILE. DO NOT INSTALL WHEN -Y- LINES ARE WITHIN 0.5 MILES FROM "END ROAD WORK" SIGN. - FOR TEE INTERSECTIONS, INSTALL WITHIN 500' +/- OF THE INTERSECTION ALONG -L- LINE.	
	5	 G20-2 A 48" X 24"	PLACE 500' FOLLOWING THE END OF CONSTRUCTION LIMITS OR AS SHOWN WHEN WORK ENDS AT A 3-WAY TEE INTERSECTION.	

NO REQUIRED STATIONARY SIGNING FOR THE FOLLOWING -Y- LINE CONDITIONS:

- 1) LESS THAN 1000' OF RESURFACING ALONG -Y- LINE
- 2) SUBDIVISION ROADS
- 3) DEAD END ROADS

WHEN PAVING/CONSTRUCTION ACTIVITIES PROCEED ACROSS AN UNSIGNED -Y- LINE, PORTABLE ADVANCE WARNING SIGNS SHALL BE USED ALONG THE -Y- LINE AS SHOWN BELOW. REMOVE UPON COMPLETION OF WORK.

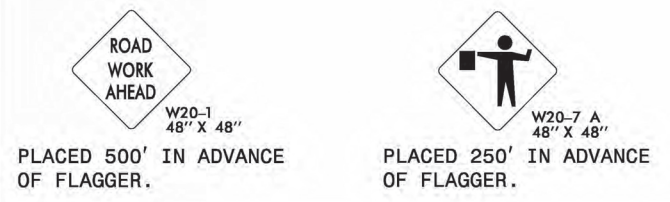

MAPS LESS THAN 2 MILES

FOR RESURFACING MAPS WITH CONSTRUCTION LIMITS LESS THAN 2 MILES IN LENGTH, NO STATIONARY SIGNS ARE REQUIRED. USE PORTABLE "ROAD UNDER CONSTRUCTION" OR "ROAD WORK AHEAD" SIGNS IN LIEU OF STATIONARY ADVANCE WARNINGS SIGNS.

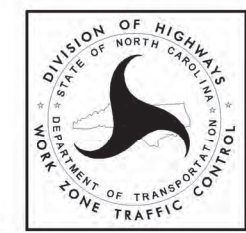

ADVANCE WARNING SIGNS FOR RURAL AND SUBURBAN 2-LANE ROADWAY RESURFACING

5/15/2017 S:\TMD\WZTC\Resurfacing\2L2W & AST Resurfacing Details\Resurfacing_AdvWarn_2Ln.dgn User:kdals

- NOTES:
- 1) DETAIL DOES NOT APPLY TO OGAFB AND ULTRA-THIN BONDED WEARING COURSE.
 - 2) BACKFILL SHOULDER WITH APPROVED MATERIAL.
 - 3) THE SHOULDER WEDGE DEVICE MAY BE DISENGAGED AT PAVED DRIVEWAYS AND SIDE STREETS.

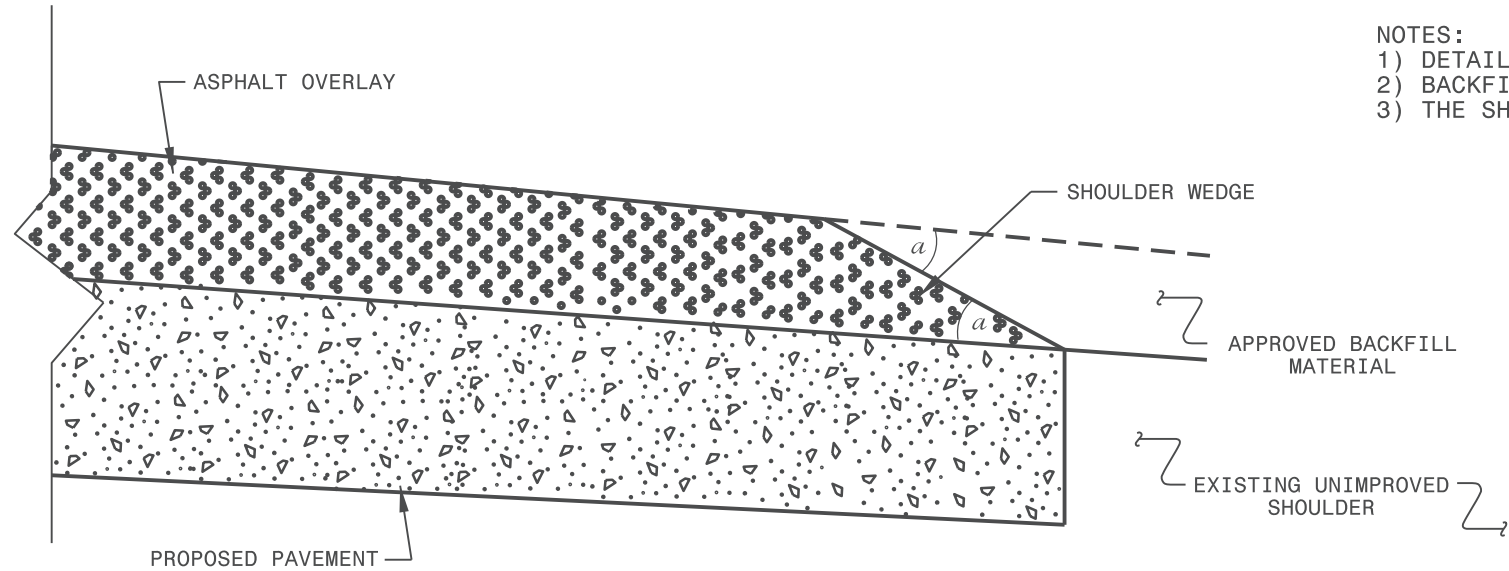

SHOULDER WEDGE DETAIL
 (Resurfacing Projects w/ Widening or
 with Existing Paved Shoulder having no dropoffs)

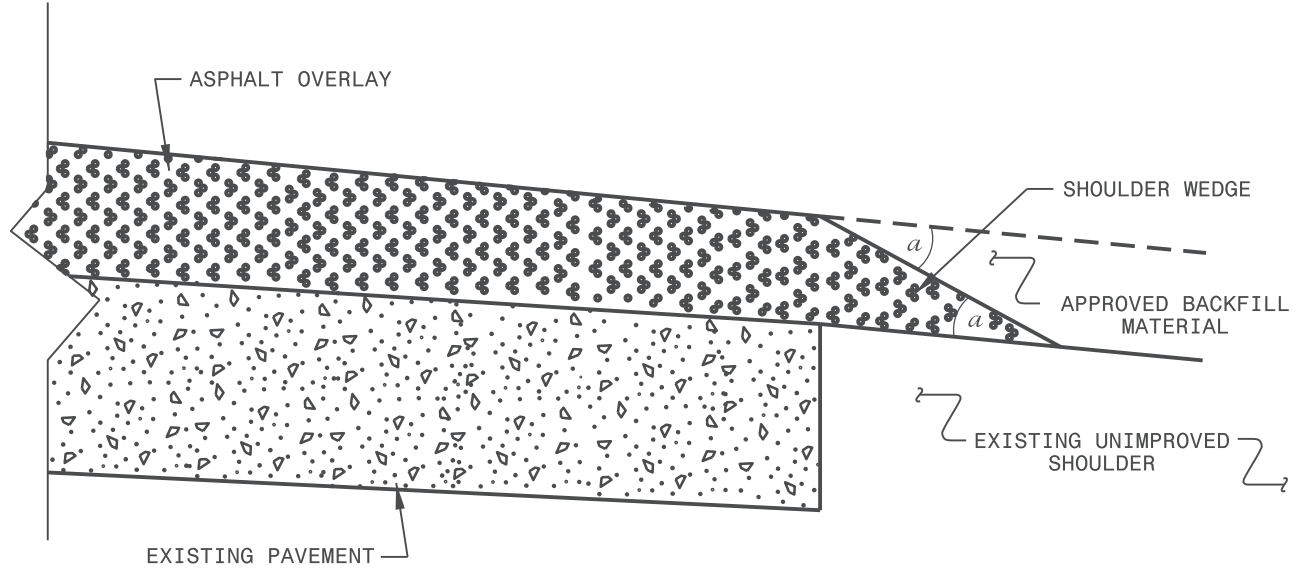

SHOULDER WEDGE DETAIL
 (Resurfacing Projects w/ NO Widening)

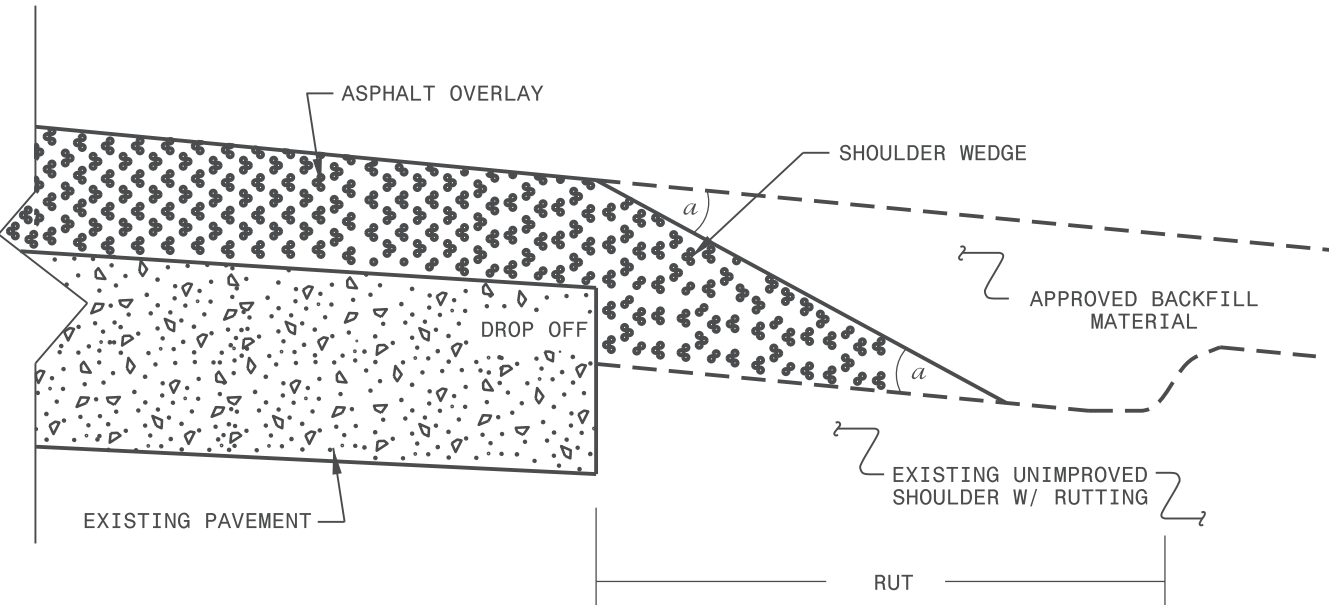

SHOULDER WEDGE DETAIL
 (Resurfacing Adjacent to
 Rutted Shoulder)

- SHOULDER WEDGE ANGLE = 30°

CONTRACT STANDARDS AND DEVELOPMENT UNIT			
Office 919-707-6950		FAX 919-250-4119	
SHOULDER WEDGE DETAILS			
ORIGINAL BY: T.SPELL	DATE: 7-19-11		
MODIFIED BY:	DATE: 10/16/12		
CHECKED BY:	DATE:		
FILE SPEC.: susr/details/stand/shoulderwedgedetail.dgn			

SYSTEMS DESIGN USER NAME